

BOA ® CORDLESS AIR PUM – USER MANUAL

Model BP 01072



BOA®

Lithium system airpump

General information

Dear customer,

This user manual contains a description of the product and important guidances to ensure a correct and safe usage of the product. It is important prior to use to read this manual carefully. It is especially important to read the safety requirements and follow these. We continuously develop our products and we reserve the right without further notice to change the specifications and functions of products.

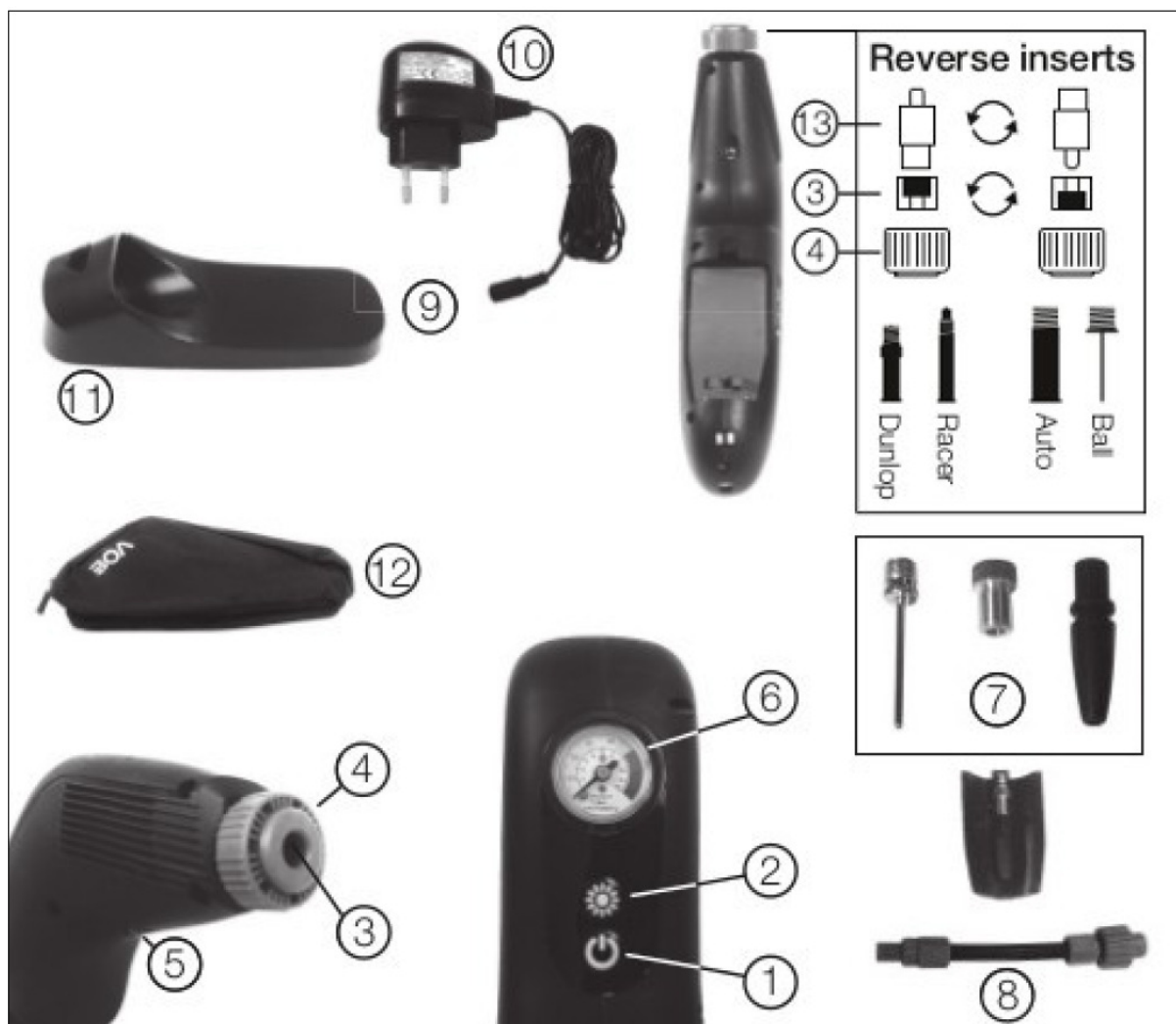

Content of the package

- | | |
|-------------------------------------------|-----------------------|
| 1. Start – stop switch | 8. Adapter hose |
| 2. Light switch | 9. DC Input |
| 3. Valve rubber | 10. AC Charger |
| 4. Union ring | 11. Pump holder stand |
| 5. Night light | 12. Carrying bag |
| 6. Illuminated pressure gauge 0 – 150 PSI | 13. Valve adapters |
| 7. Adapter set – 3 pcs. inside pump. | |

General safety measures and precautions

The safety measures specified below must be closely followed! Read them before you start using the air pump. Safe operation of the air pump requires that you must read the instructions and safety precautions carefully and follow all instructions before using the air pump.

- This appliance can be used by children aged from 8 years and above and persons with reduced physical, sensory or mental capabilities or lack of experience and knowledge if they have been given supervision or instruction concerning use of the appliance in a safe way and understand the hazards involved
- Children shall not play with the appliance.
- Cleaning and user maintenance shall not be made by children without supervision
- The air pump is designed for occasional use. Inflation over a long period will overheat the air pump and may ruin it.
- The air pump must not operate for more than 10 minutes at a time, after which it must be switched off and set aside for cooling for at least 10 minutes before restarting.
- If the air pump emits abnormal sounds or overheats, turn it off immediately and let it cool off for about 30 minutes.
- Check the air pump and battery before use. An expert should repair damaged parts. Incorrect use of the air pump may damage it.
- Never expose the air pump or battery to rain or frost or temperatures above 50° C. Never charge the battery in humid or wet locations.
- Never use the air pump near flammable fluids or gases. Make sure your working area is well lit.
- Protect yourself against electric shock. Avoid physical contact with grounded surfaces such as pipes, radiators, electric stoves, refrigerators, etc.
- Never allow children to connect/disconnect the air pump to/from power sources. Never leave children unattended with the air pump and never allow them to play with the accessories.
- Never allow anyone to pump air into the mouth, ears, nose or the like of people or animals. Never use the air pump as a toy.
- Store the air pump in a secure location. If the air pump is not used for long periods of time, it should be stored in a dry, locked space inaccessible to children.
- Regularly check the cord of the charger. Never carry the charger by the cord and never pull the plug out of the outlet by jerking the cord. Make sure that the cord is not exposed to hot objects, oil or sharp edges.
- Keep the air pump clean to achieve maximum output and safety. Examine the plug, charger and cord at regular intervals and have them repaired by an expert if they are damaged.
- Pull the charger plug out of the plug socket when the charger is not in use.
- Never charge the battery outdoors.
- Do not open the battery, only open the pump and remove the battery if the pump is scrapped.
- Protect the pump and battery against impact. The pump should be stored in a dry, frost-free place.
- The battery and charger are designed for each other. Only use the original enclosed charger for charging.
- Protect the pump against heat and fire: danger of explosion!
- Do not place the pump on a heater and do not expose it to solar radiation for a long period. It is damaged at temperatures above 50° C. Allow hot batteries to cool off completely before charging.
- Stay alert. Always pay attention to what you are doing when working with the air pump.

Instructions

Always read the instruction manual before using the Cordless Air-pump for the first time – it gives instructions on how to make optimum use of the air pump and what precautionary measures should be taken in connection with its use.

Your new cordless air pump has been specially designed for simple and efficient inflation. The air pump provides a small quantity of air at a relatively high pressure — this means that this air pump is not suitable for inflating large inflatable objects requiring a large airflow at low pressure, such as air-mattresses, inflatable beach toys and inflatable furniture.

Important – do not run the air pump for more than 10 minutes in continuous operation mode – and after 10 minutes allow it to cool for a minimum of 10 minutes.

Your air pump is equipped with a union valve (4). When you want to pump up an object, loosen the union valve (counter-clockwise) and push it down over the valve on the object to be inflated — if this cannot be done, fit a suitable adapter. Tighten the union valve again (clockwise) and pump.

Loosen the union valve again before removing the air pump from the object or taking out the adapter.

Inflating Balls

Loosen the union valve (4) and press the Threaded end at a-ball adapter (5) into the union valve, lighten the union valve again so that the ball adapter is secured.

Carefully push the pointed end of the ball-adapter into the ball's valve.

Then press the start switch (1) and pump.

Carefully remove the ball adapter from the ball.

Loosen the union valve again to remove the ball adapter from the union valve.

Inflating Bicycle, Wheelchair, Scooter

Loosen the union valve (4) and fit the pump onto the valve.

If the pump do not fit for the valve, fit a suitable adapter.

For bicycle valves with a French valve (typically racing bike), loosen the valve screw only halfway before fitting the bicycle adapter onto the valve.

Tighten the union valve (4) again.

Then press the start switch (1) and pump.

Loosen the union valve (4) again before you remove the air pump from the tire valve

Accessories

The pump is equipped with 3 pcs adapter set (7);

Bicycle adapter, ball needle, balloon adapter and a short hose adapter.

Technical data	Model BP 01072
Maximum pressure	145 PSI / 10 bar
Air flow	9L / min
Max current	11A
Rated voltage	DC 7,2V
Li-ion battery cap.	2000 mAh
AC charger Input	110/230V
AC charger output	9V - 1.000 mA
Pump Size	5 x 240 mm
Bike tire 0 - 75 PSI	30 Sec
Bike tire 0 - 150 PSI	90 Sec

Warning!

This air pump is maintenance free, having self-lubricating piston. Do not wash pump inside the housing.

Cleaning the pump is done with a damp cloth on the outside housing.

For your own safety you should only use accessories and other parts that are specified in the instructions or recommended for use by the manufacturer. Use of accessories and other parts that are not mentioned in the instructions may entail an increased risk for the user of the air pump.

Charging the battery

For optimum use of your new cordless air pump, you should ensure that the battery is always charged.

Connect the charger to the Pump or Charge stand, connect the charger to a 110V / 230V power source and switch on.

A small indicator lights up red as long as the battery is not fully charged – it will switch into green for indicating that the battery is fully charged.

The accompanying battery can be recharged at least 500 times.

- ✓ Rechargeable battery: 7.2V Li-ion , 2000 mAh.
- ✓ Charging time for the first charge using the accompanying AC charger: 5 hours.
- ✓ Subsequent charges: 1 – 2 hours — depending on discharge.
- ✓ In order to preserve the battery's capacity, it should be almost fully discharged once in a while.
- ✓ With correct use, the battery can be recharged at least 500 times
- ✓ AC charger Input / Output: 110/230V / 9V – 1.000 mA.

Batteries and Environment

The battery must be removed from the appliance before it is scrapped.

To take out the battery:

1. The appliance must be disconnected from the supply mains when removing the battery.
2. Open the pump and disconnect the wires at the battery – avoid any shortcut between wires !!
3. The battery is to be disposed of safely BOA International and your local retailer accept returned used air pumps. Dispose of a defective pump, must be done in an environmentally friendly manner – do not leave it in nature, do not burn it and never open the pump/battery.

Warranty

A 1-year warranty is provided for BOA air pump, covering defects in material or production under statutory provisions.

EU / CE compliance declaration

BOA International declares under general liability that this product complies with the following standards or normative documents: EN 50 144, EN 55 014, EN 55 104 (battery-powered tool) or EN 60 335, EN 60 555, EN 55 022, EN 50 0811, EN 61 000-3-2, EN 61 000-3-3 (battery-powered charger unit) according to the provisions in directives 89/392/EEC, 89/336 EEC from (1/96), 91/368 EEC, CE approved.